

Q-Park Sauchiehall Street Glasgow, UK

EPA Award 2011
Renovated Structures



Description

- Prime city centre location
- Sauchiehall Street has 375 spaces and serves shoppers, leisure users and hotel customers
- The project's aim was to enhance customer perception and service delivery
- The original car park was built in the early 1970's
- The renovation project reduced the number of spaces from 404, demonstrating that customer service standards was the priority
- The car park remained operational throughout the renovation project

Identification and access

- Traffic lights direct drivers from the main road
- Speed gates at vehicle entrance/exit
- Secure pedestrian access
- Bright and welcoming entrance

Before

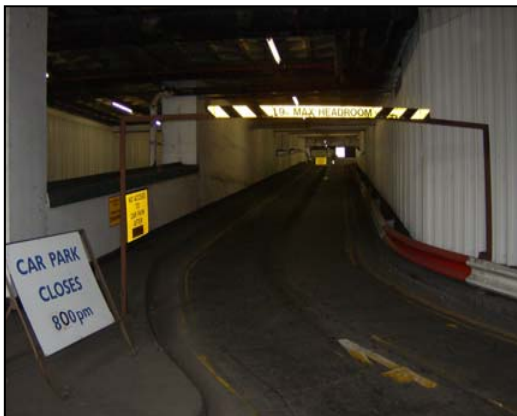

After



Q-Park Sauchiehall Street, Glasgow, UK – Renovated Structures

Design aesthetics

■ New circulation route

Before

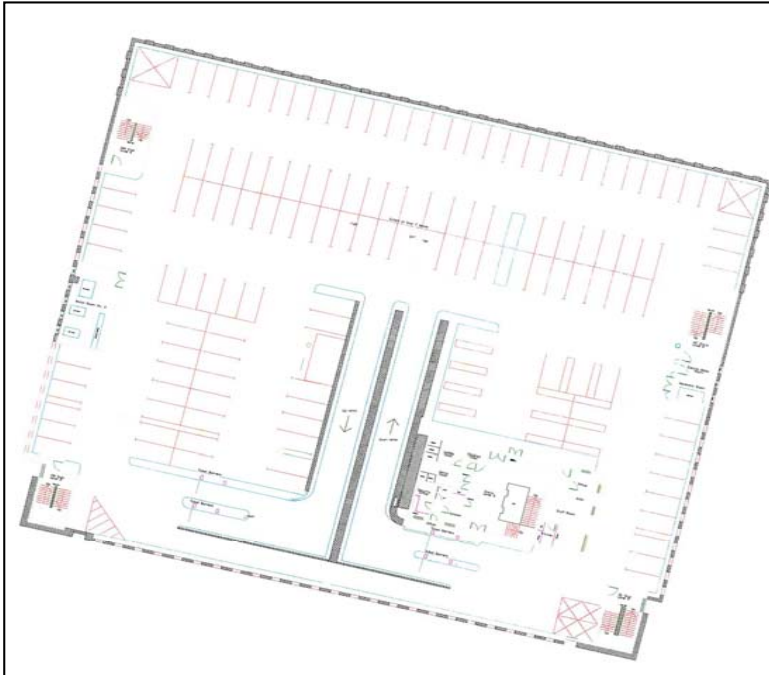

After

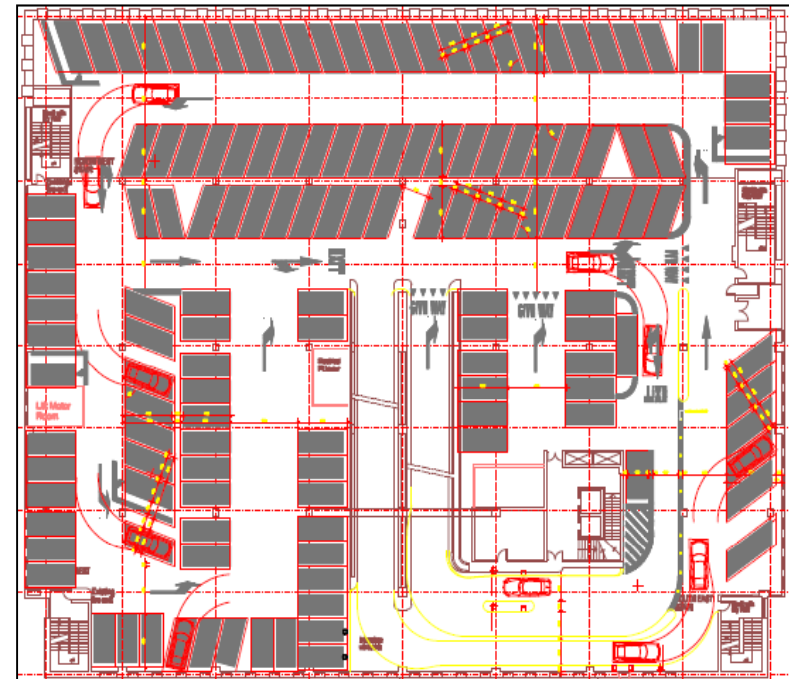

Construction characteristics

- New Parking Host Lodge
- Materials chosen for long-term durability, low maintenance and ease of cleaning

Before



After



Q-Park Sauchiehall Street, Glasgow, UK – Renovated Structures

Quality of finish

- Bright, clean spacious environment
- New floor coating and painted ceilings
- New energy efficient lighting system

Before



After



Disabled access

- Clearly identifiable disabled bays on every level
- Located close to the lifts

Before



After



Pedestrians and routing

- Removing cluttered and inconsistent signage with a new clear and easy to understand package
- Different coloured signs for vehicles and pedestrians (red & green respectively)

Before



After



Parking equipment

- New, reliable integrated parking management system
- Easy entry and exit
- Convenient payment options

Before



After



Q-Park Sauchiehall Street, Glasgow, UK – Renovated Structures

The results

- New lighting system resulted in a reduction of c55% in energy usage
- Weekly revenue figures are greatly improved post renovation

