

Grote Markt Tongeren, Belgium

EPA Award 2013

Category Renovated projects

Grote Markt Tongeren

City environment

- | Opening: 5th of November 2012
- | 126 spaces to serve:
 - | Residents and their visitors
 - | Visitors and employees of shopping streets
 - | Tourists
- | Main features renovation:
 - | Additional ramp
 - | Accessible entrance for cars
 - | Safer pedestrians entrance
 - | Renovated stairwell



- 1 Parking Julianus, 228 pp
- 2 Parking Clarissenstraat, 75 pp
- 3 Parking Grote Markt, 126 pp

Grote Markt Tongeren

Identification and access

- I Picture of entrance road signs, entrance of the parking facility, access pedestrians

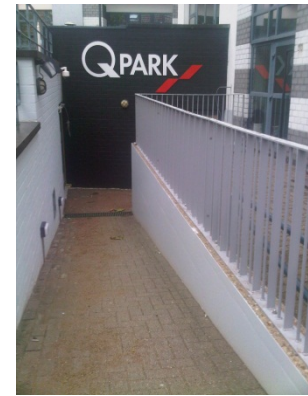
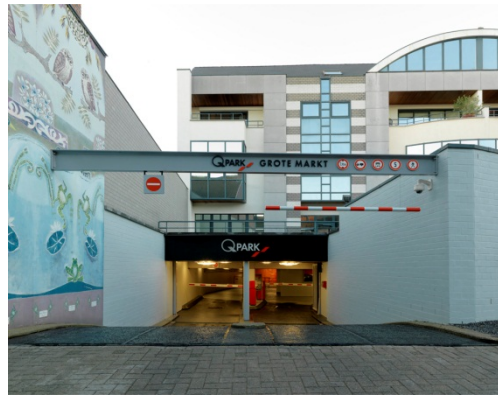

- I The parking facility is located nearby the market place of Tongeren and easy to reach from the ring way

Grote Markt Tongeren

Surrounding townscape

The following considerations have been made to ensure the contribution to a better townscape:

- | Reduction of surfaced parking spaces
- | Accessibility of the underground parking facility directly from the main ring way, avoiding automobile traffic in the city centre
- | Less CO₂ emission in the inner city



Grote Markt Tongeren

Entrance/ Exit area – Column situation

Before



After



Grote Markt Tongeren

Payment equipment – Pedestrian zones

Before



After



Grote Markt Tongeren

Layout, routing & orientation

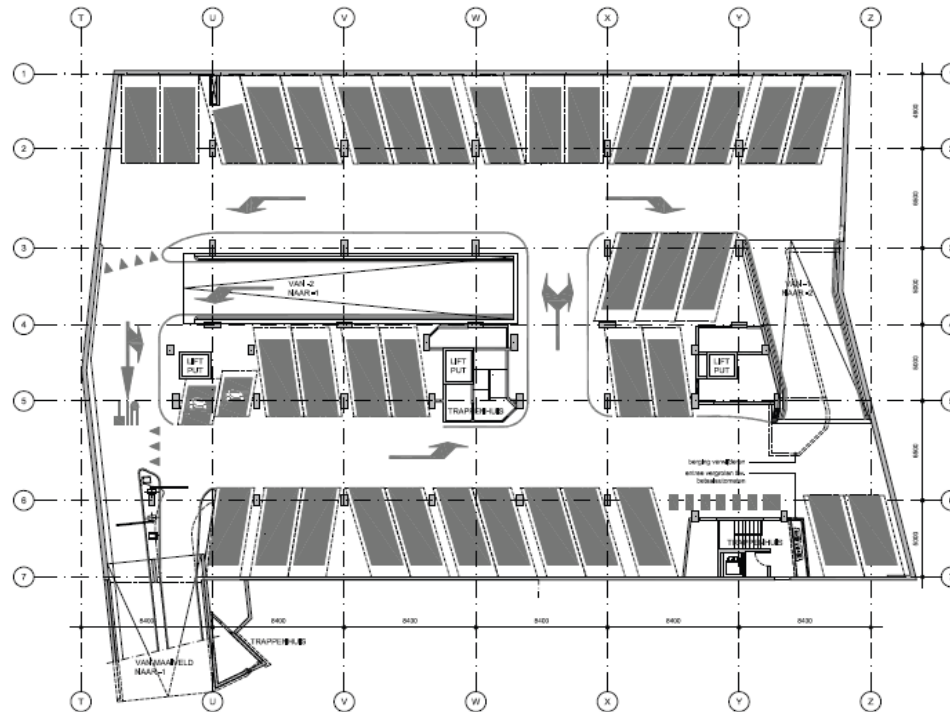

Before



After

Grote Markt Tongeren

Safety, security, lighting

Before



After

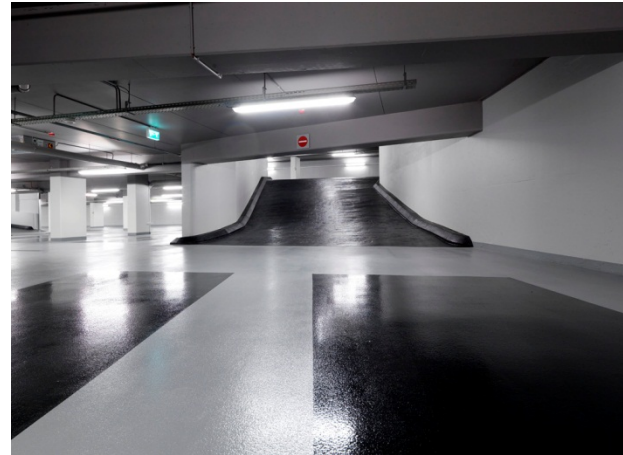

Grote Markt Tongeren

Customer Services

Alcoholtester

i



AED



Off-site Hosts



Grote Markt Tongeren

Special Feature – Additional ramp

- | To improve accessibility and traffic flow, an additional upwards ramp (2 levels) was built in the heart of the parking facility.
- | The former two way ramp became a downwards ramp.

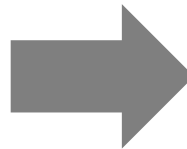

Grote Markt Tongeren

Some usage information

- | Before: Open barrier due to operational problems
- After: Safe well-functioning parking facility



- | Tariff:
 - | € 1,50/hour
 - | € 13,50/day
- | Parking spaces: by building a new ramp, the number of accessible parking spaces increased from 50 to 126 (before the renovation levels -2 and -3 were practically inaccessible)

